

iMicro Q
User Guide

Components:



iMicro Q



Shim pad



Reflecting pad



μ Ruler



Storage case/stand

Introduction

iMicro Q works with your smartphone to observe tiny objects and record digital micrographs as a portable digital microscope.

Install the APP

Scan the QR code to download and install the APP i-SEEING. For Android version, you need to set the permission by going to Setting->permission setting->App permission setting->i-Seeing to set camera to be accessible.

Shanghai QingYing E&T LLC



iOS App at Apple App Store



Android APP at Google Play

Shanghai QingYing E&T LLC

Apps are also accessible from website (www.mobile-scope.com).

Install iMicro Q

Pull it from the storage case, align the lens with phone camera and the light guide with flash, attach it to the phone through its nano-suction pad.

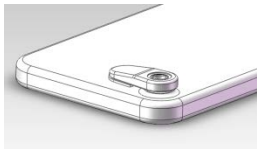

For phones with extruded camera, shim pad can compensate the height difference between camera and phone surface.

Make observation

Turn on the flash light, put iMicro Q against the objects to observe, the phone will make autofocus and clear image will appear on screen.

The storage case can be used as a stand to assist observation.

When observe transparent samples, such as μ Ruler or sample slide, the reflecting pad can be

Shanghai QingYing E&T LLC

used to reflect light to illuminate the sample.

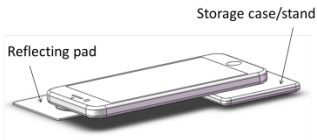

The μ Ruler

5 types of ruler can help you in the calibration of the scale bar in APP, to enhance the capability with size measurement.

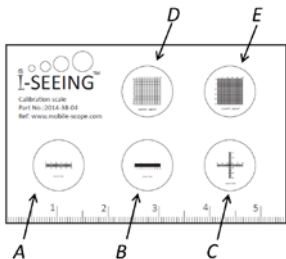

- A. 0.1mm line ruler
- B. 0.05mm line ruler
- C. 0.1mm cross ruler
- D. 0.5mm grid ruler
- E. 0.2mm grid ruler

Calibrate the scale bar

If you want to measure the size of micro-objects, you need to calibrate the scale bar.



Make observation of the μ Ruler, enter the calibration mode* by pushing the gear button

*The calibration code is on the label on the storage case, under the bar code.

and tune the magnification number to match the scale bar with the real length of the μ Ruler.

Maintenance

- ◆ Clean the surface with soft cloth, no organic solvent should be used.
- ◆ Keep the lens free of dust, clean the lens with soft lens tissue.
- ◆ The nano-suction pad on the backside of the device can be cleaned with PSA tape if it is contaminated by dust.

Specification

- ◆ Magnification: ~100-800X
- ◆ Max view field: ~1mm
- ◆ Size: ~26mmX12mmX3.5mm
- ◆ Weight: ~1.5g

iMicro Q
使用指南

部件:



iMicro Q



垫片



反光片



显微尺 μ Ruler



存储盒/支撑架

简介

iMicro Q 可以与您的手机一起作为便携数码显微镜来观察细小物体和记录显微图像。

安装 APP

手机扫描相应二维码下载并安装 APP i-SEEING. 对于安卓版本，您可能需要手动设置许可，允许它使用您的相机和存储才能很好的工作。可以到设置->权限管理->软件权限管理->i-Seeing 设置为可以使用相机。



iOS App 苹果应用商店



安卓 App Google Play

上海庆赢电子科技

您也可以访问本公司网站下载安装 APP(www.mobile-scope.com)。

安装 iMicro Q

将 iMicro Q 镜头和导光孔对准手机摄像头和闪光灯，通过其背后的纳米吸盘吸贴在手机上。

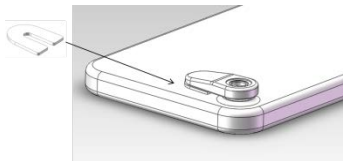

如果手机摄像头是突起的，可以用所附垫片来补偿突起的高度差，以使 iMicro Q 在手机上连接稳固。

观察样品

打开闪光灯，将显微镜靠是要观察的样品上，相机会自动对焦呈现清晰图像。

为了方便观察，储存盒可以用作支撑架辅助观察。

对于透明样品的观察，比如显微尺或制备好的样品玻片，可以将反光片置于样品下面将闪光灯的光线反射提供反射照明。

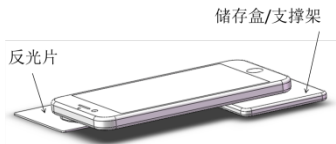

显微尺

所附显微尺包括 5 种不同类型，方便您对 APP 中的标尺进行校准，加强显微镜的功能。

- A. 0.1mm 分度直尺
- B. 0.05mm 分度直尺
- C. 0.1mm 分度十字尺
- D. 0.5mm 分度网形尺
- E. 0.2mm 分度网形尺

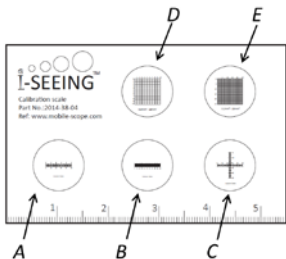

嵌入标尺的校准

为了精确测量您可以对嵌入标尺进行校准。

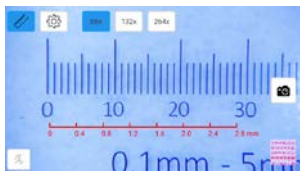

通过设备观察显微尺的图像，点按齿轮按钮进入校准模式*。通过输入合适的放大倍数，使嵌入标尺与显微尺的实际长度相一致。

*校准密码在储存盒的标签上,位于条码下面。

维护保养

- ◆ 用软布清洁设备表面，不可用有机溶剂或腐蚀性液体；
- ◆ 请保持镜头清洁，万一镜头需要清洁请用软质镜头纸清洁；
- ◆ 设备背面的纳米吸盘因沾污吸附力不足时，可以用压敏胶带粘除上面灰尘。

规格

- ◆ 放大倍数: ~100-800X
- ◆ 最大有效视野: ~1mm
- ◆ 尺寸: ~26mmX12mmX3.5mm
- ◆ 重量: ~1.5 克

©2018 Shanghai QingYing E&T LLC. All rights reserved.

©2018 上海庆赢电子科技有限公司，保留所有权利。